

Isotop® MSN

All metal steel spring vibration isolators

by reinicke
isotop®

Design

Isotop® MSN steel spring vibration isolators consist of two spring elements with M8 internal thread and a cylindrical screw spring according to DIN EN 13906-1:2001, tolerances according to DIN 2095. The spring elements and the screw spring are inseparably connected with a special 2-component compound. On request MSN steel spring vibration isolator can be galvanized or cataphoresis coated with RAL 9005 (deep black). Special coatings or colours are possible on request.

Field of application

Isotop® MSN elements have a natural frequency, depending on the load, down to approx. 3.5 Hz and are mainly used for:

- Compressors
- Extractors
- Small ventilators
- Small fans
- Audio loud speakers
- Pumps
- Emergency power units

Required data for selection

- Total weight to be absorbed
- Number and location of points of support
- Centre of gravity
- Structural shape of the device
- Direction of load
- Lowest disturbing frequency (rotational speed or number of strokes)

Advantages

- Low construction height
- Low resonant frequency
- Construction height, diameter and connection thread are identical for all types which guarantees exchangeability
- Condition of spring elements is clearly visible due to the open construction
- Durable, compact design



Isotop® MSN, galvanized



Isotop® MSN, KTL

Our service

Make use of our know-how on questions about vibration technology. We will gladly consult you and will calculate tailor-made solutions for vibration isolation.

Isotop® MSN 1 - MSN 4

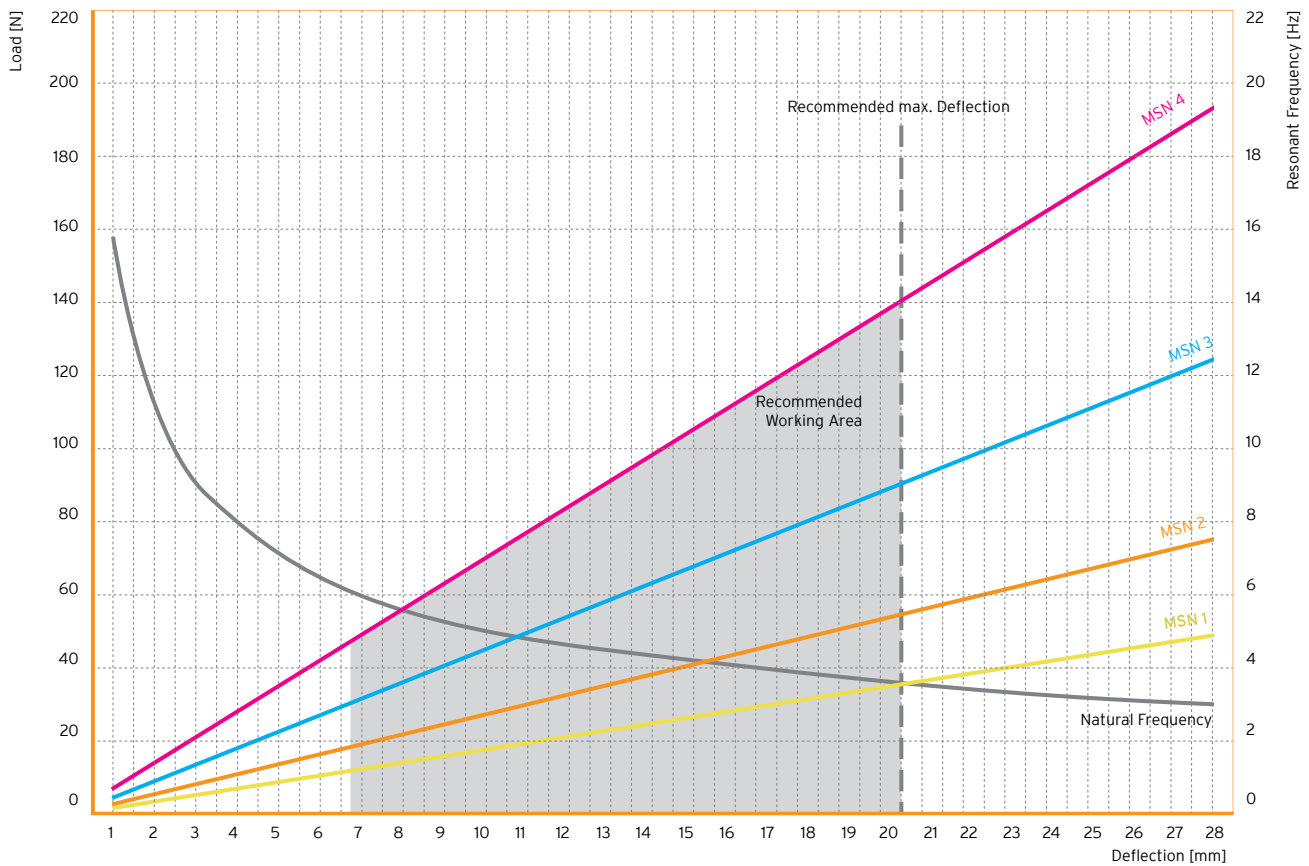

Remark: Loads higher than the recommended deflection are possible. Please then take into account that the deflection caused by additional dynamic loads has an upper limit. In such cases please ask Reinicke GmbH.

Isotop® MSN 5 - MSN 8

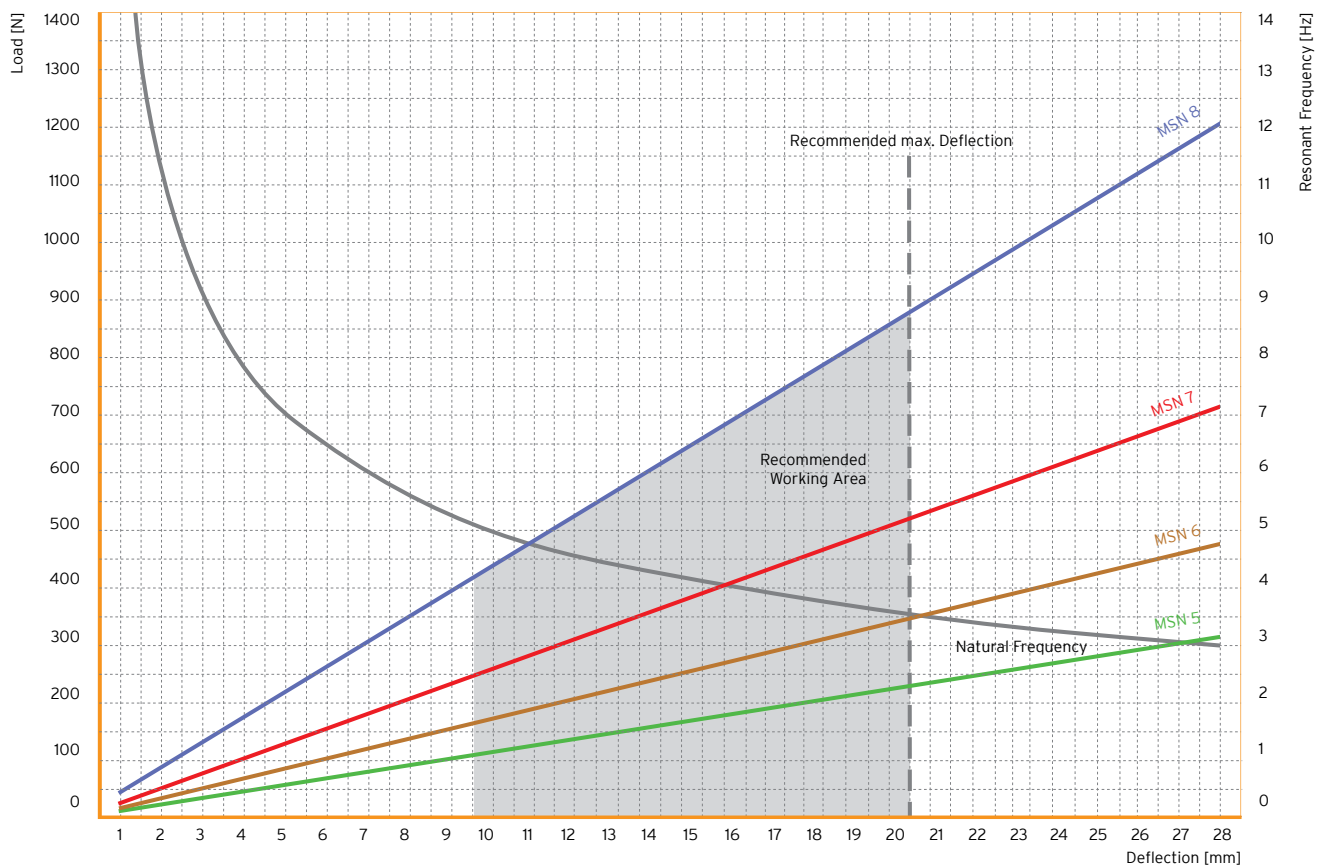

Remark: Loads higher than the recommended deflection are possible. Please then take into account that the deflection caused by additional dynamic loads has an upper limit. In such cases please ask Reinicke GmbH.

Selection Table

DESCRIPTION	REF. NO., GALVANIZED	REF. NO., KTL	NOMINAL RANGE min./max.	SPRING RATE
Isotop® MSN 1	45000171	45000181	18 N - 45 N	1.78 N/mm
Isotop® MSN 2	45000172	45000182	27 N - 70 N	2.73 N/mm
Isotop® MSN 3	45000173	45000183	45 N - 115 N	4.52 N/mm
Isotop® MSN 4	45000174	45000184	70 N - 175 N	7.02 N/mm
Isotop® MSN 5	45000175	45000185	115 N - 285 N	11.44 N/mm
Isotop® MSN 6	45000176	45000186	175 N - 435 N	17.30 N/mm
Isotop® MSN 7	45000177	45000187	285 N - 650 N	26.02 N/mm
Isotop® MSN 8	45000178	45000188	440 N - 1,100 N	43.85 N/mm

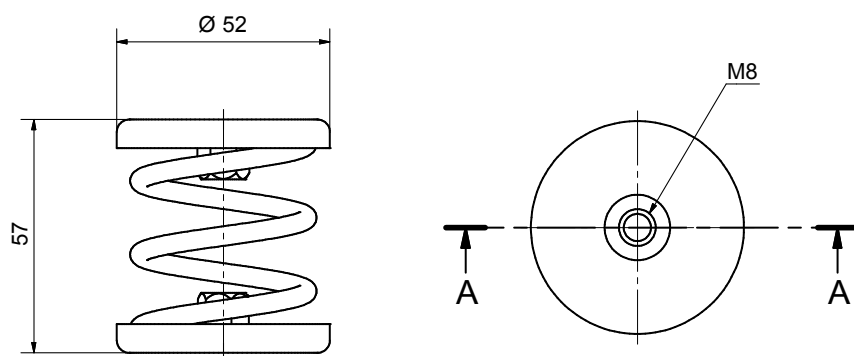

All data indicated are based upon our current knowledge.
They may be used as calculation and standard values and are subject
to the usual machining tolerances. Subject to change and correction.